



## GCT-2G 350 GREASE TRAP

SKU:111-001-A000

Stainless steel grease trap (grease interceptor) for free-standing installation at commercial kitchens, restaurants, supermarkets and food processing areas, etc. Designed to treat greasy wastewater from a single fixture with a total flow rate  $\leq 1$  litre/ second.

### Specification

Standard (RSA): SANS 10252-2  
 Material (EN): 1.4301 (304) or 1.4404 (316)  
 Tank wall thickness (mm): 1.2 & 1.5  
 Surface finish: Pickled and passivated, polished  
 Flow rate (l/s): 1  
 Max grease capacity (l): 7.5  
 Solids basket: Yes, 1 of  
 Basket volume (l):  $\approx 7.5$   
 Basket dimensions (mm): 208 l X 380 w X 221 h  
 Total static water volume (l):  $\approx 27$   
 No. of lids: 1  
 Lid seal: Yes, EPDM  
 Lid sealing mechanism: Fasteners  
 Lids load class: None (non-trafficable lid)  
 Inlet/ Outlet diameter (mm): 50.8  
 Overall dimensions (mm): 450 l X 414 w X 461 h  
 Height from bottom to inlet centre (mm): 319  
 Height from bottom to outlet centre (mm): 269  
 Weight (kg): 12.5

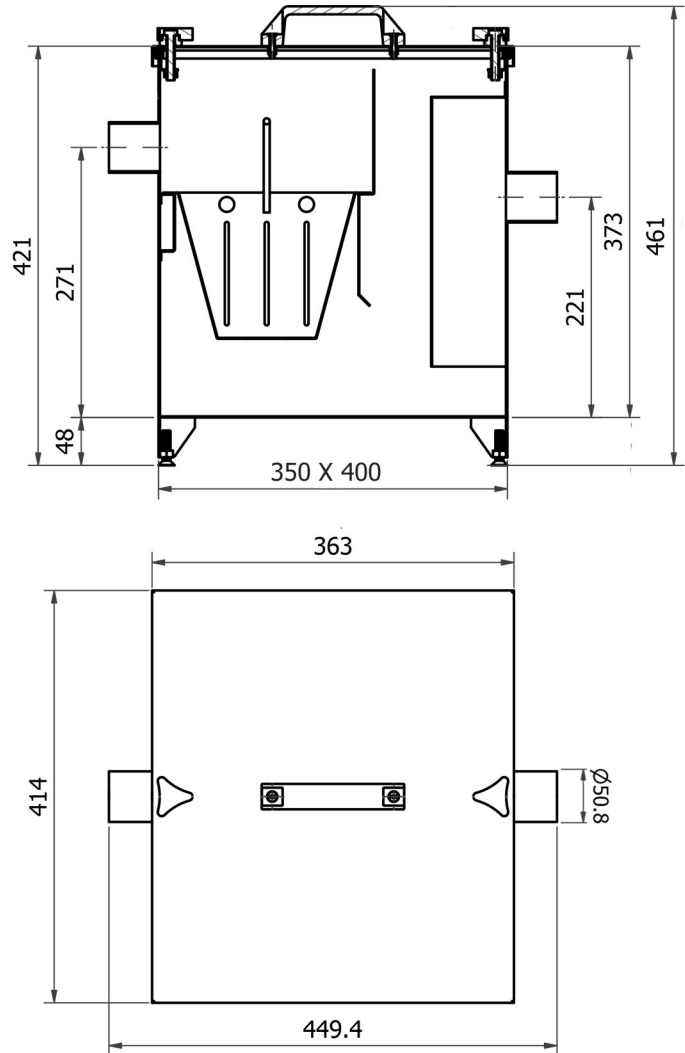

### Order Sheet:

Please mark option/s in each box with an X. \* (asterisk) indicates special order. If no options are selected the product is supplied as standard.

MATERIAL	LEGS	INLET/OUTLET SIZE
select one <b>X</b>	select one <b>X</b>	select one <b>X</b>
<input type="checkbox"/> 304 <input type="checkbox"/> 316*	<input type="checkbox"/> YES <input type="checkbox"/> NO*	NOT APPLICABLE
Note: Legs are manufactured with adjustable feet.		

Qty:	Name:	Signature:	Date:	Company:	PO no:
------	-------	------------	-------	----------	--------